

May 22 1900

Side walk grade for D. A. Murray
 # 9 on West side Grant Ave between
 27th & 28th St. file # 159
 G. K. P. Int }
 A. D. O. Rad } 2.30 P.M. to 3.30 P.M. W
 H. B. S. chain

Sta #	H.I. T.P. Cor. Elev	curb Rad	S.W. Rad	cut or Fall
B.M.	H313.44 + 2.98	S bolt to Hyd. 27th & Grant.		
H.I.	H316.42			
90+53.85	11.07	5.35-75	5.10 ✓	F0.1
90+03.85	11.43	4.99-25	4.74 ✓	F0.4
89+53.85	11.79	4.63-25	4.38 ✓	F0.3

Walk set 6 ft. from property
 line; stakes set 3 ft out side
 walk.

27th St.

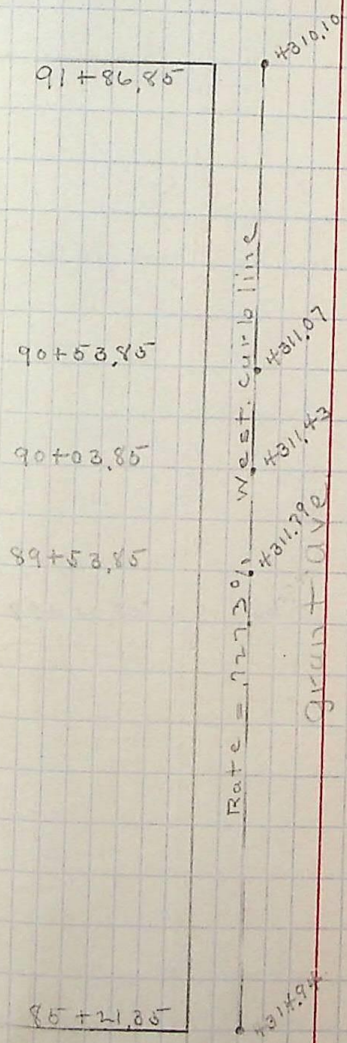

28th Str.

47th St.

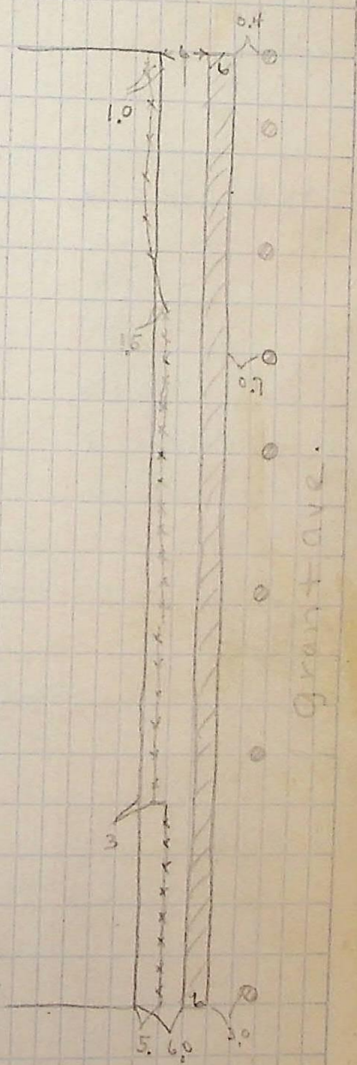

28th St.